

SMD Molded Power Inductor

GCDA1050 Series



FEATURES

- Integrated Shielding Construction
- Alloy Material with Excellent withstanding Current Characteristics
- Featured with High Inductance and Low DCR Characteristics
- Variable Inductance Value (1.0uH ~ 100uH) with Wide Frequency Range
- Operating Range: -45°C~+125°C(Including Self- Temperature Rise)
- RoHS Compliant

PART NUMBER CONSTRUCTION

GCDA1050

Series

4R7

Inductance*

M

Tolerance①

T

Packing②

① Tolerance: M = 20% N = 30%

② Packing: B = Bulk T = Tape and Reel

*Refer to Electrical Specification table

ELECTRICAL SPECIFICATIONS

| Part Number | Inductance(μH) ±20% | DCR(mΩ) | | Irms (A) | Isat (A) |
|---------------|------------------------|---------|-----|----------|----------|
| | | Typical | Max | | |
| GCDA1050-1R0M | 1.0 | 2.1 | 3.0 | 18 | 30 |
| GCDA1050-1R5M | 1.5 | 2.8 | 4.2 | 16 | 25 |
| GCDA1050-2R2M | 2.2 | 5 | 7.5 | 14 | 22 |
| GCDA1050-3R3M | 3.3 | 6.9 | 9.0 | 12 | 18 |
| GCDA1050-4R7M | 4.7 | 12 | 16 | 9 | 15 |
| GCDA1050-6R8M | 6.8 | 17 | 23 | 8 | 13 |
| GCDA1050-100M | 10 | 25 | 32 | 7 | 12 |
| GCDA1050-150M | 15 | 36 | 47 | 6 | 10 |
| GCDA1050-220M | 22 | 63 | 75 | 5 | 8 |
| GCDA1050-330M | 33 | 76 | 88 | 4 | 6 |
| GCDA1050-470M | 47 | 110 | 130 | 3.0 | 5.5 |
| GCDA1050-680M | 68 | 160 | 180 | 2.5 | 4.5 |
| GCDA1050-101M | 100 | 240 | 270 | 2.0 | 3.5 |

PRODUCT DIMENSIONS

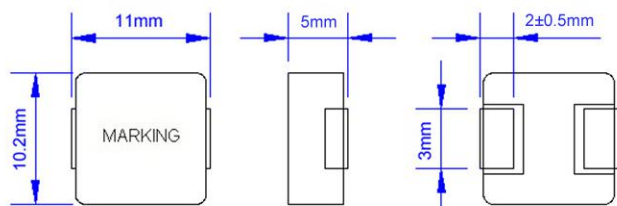

RECOMMENDED LANDING PATTERN

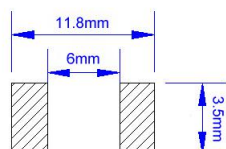

MATERIALS & STRUCTURE

Core: Alloy Powder

Wire: Copper

Terminal: Nickel Plating

Ink: Black

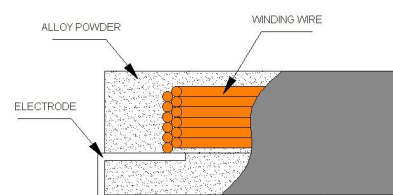

PACKING

800PCS/REEL